

PRO SAT



1. Introduction

Welcome to the ProSat. Please take a little time to read this manual and to follow, as far as practical, the installation guidelines it contains. We would also draw your attention to the **Important Safety Instructions** on this page. Careful installation will help ensure that your ProSat performs optimally. Should you have any questions not covered here we are happy to try and answer them either by telephone or email.

The ProSat is a relatively delicate precision engineered product that can be damaged by inappropriate handling. It is also large and heavy. Please take great care therefore when unpacking or moving it. Plan any handling in advance of carrying it out - ideally with a second person to help. Please take care when unpacking or moving the ProSat not to touch any of the drivers. Damage to a driver will at best degrade performance and at worst result in complete failure.

The enclosure surfaces should also be handled sympathetically. Any cleaning should only require a lint-free cloth or a soft brush. Be wary of using any polishes or solvent based cleaning agents.

Important Safety Instructions

Ensure that your ProSub is set to the appropriate mains input voltage before it is connected to a mains socket. The warranty does not cover damage caused by incorrect mains voltage.

1. Read these instructions.
2. Keep these instructions.
3. Heed all warnings.
4. Follow all instructions.
5. Do not use this apparatus near water.
6. Clean only with dry cloth.
7. Do not block any ventilation openings. Install in accordance with the manufacturer's instructions.
8. Do not install near any heat sources such as radiators, heat registers, stoves, or other apparatus (including amplifiers) that produce heat.
9. Do not defeat the safety purpose of the grounding-type plug. A grounding type plug has two blades and a third grounding prong. The third prong is provided for your safety. If the provided plug does not fit into your outlet, consult an electrician for replacement of the obsolete outlet.
10. Protect the power cord from being walked on or pinched particularly at plugs, convenience receptacles, and the point where they exit from the apparatus.
11. Only use attachments/accessories specified by the manufacturer.
12. Use only with the cart, stand, tripod, bracket, or table specified by the manufacturer, or sold with the apparatus. When a cart is used, use caution when moving the cart/apparatus combination to avoid injury from tip-over.
13. Unplug this apparatus during lightning storms or when unused for long periods of time.
14. Refer all servicing to qualified service personnel. Servicing is required when the apparatus has been damaged in any way, such as power-supply cord or plug is damaged, liquid has been spilled or objects have fallen into the apparatus, the apparatus has been exposed to rain or moisture, does not operate normally, or has been dropped.
15. The apparatus shall not be exposed to dripping or splashing and that no objects filled with liquids, such as vases, shall be placed on the apparatus.
16. The MAINS plug is used as the disconnect device, the disconnect device shall remain readily operable.
17. To reduce the risk of fire or electric shock, do not expose this apparatus to rain or moisture.



2. Applications

ProSat is intended to be used in stereo pairs for compact, desktop audio monitoring, either with or without a subwoofer, or for front, centre and surround channel applications in a 5.1 channel monitoring system incorporating a ProSub subwoofer.

ProSat may be desk mounted using the supplied adhesive rubber feet or wall mounted using clamp-style speaker mounting brackets or an Omnimount 20.5 WB speaker mounting bracket or equivalent. Blind pilot holes suitable to attach the Omnimount bracket are pre-drilled in the underside of the ProSat enclosure. Attach the bracket using No.8 (4mm) wood screws no longer than 25mm.

Blind pilot holes appropriate for an Acoustic Energy Pro ST0822 "top-hat" style speaker stand mounting plate are also pre-drilled in the underside of the ProSat enclosure. Attach the plate using No.8 (4mm) wood screws no longer than 25mm. Contact Acoustic Energy or your local distributor for information on the supply of top-hat mounting hardware.

Note: Once a ProSat has had brackets or top-hat plates fitted using screws, its enclosure will no longer be airtight if the bracket or plate is removed. In these cases the screws should always be replaced in their holes.

3. Positioning

If you are already familiar with the characteristics of your studio, and the way speakers perform in it, you may already have a good feel for where to position ProSats. However, installing any new component provides a good opportunity to review an existing set-up and perhaps make improvements.

Note: ProSat is optimised to provide a balanced tonal response when located in relative proximity to a room boundary (usually the front wall) or a large workstation surface or mixing desk. If they are positioned well clear of any boundaries some monitor chain equalisation may be appropriate.

The following paragraphs offer guidelines for ProSat positioning in both stereo and 5.1 monitoring applications. Don't worry if, thanks to the architecture or layout of your studio, it is not practical to follow the guidelines exactly. The most important thing is to experiment with the different options that are practical and find the best one.

Once your ProSats are connected and working, and you begin to become familiar with their performance, it is likely to be worthwhile experimenting a little more with positioning.

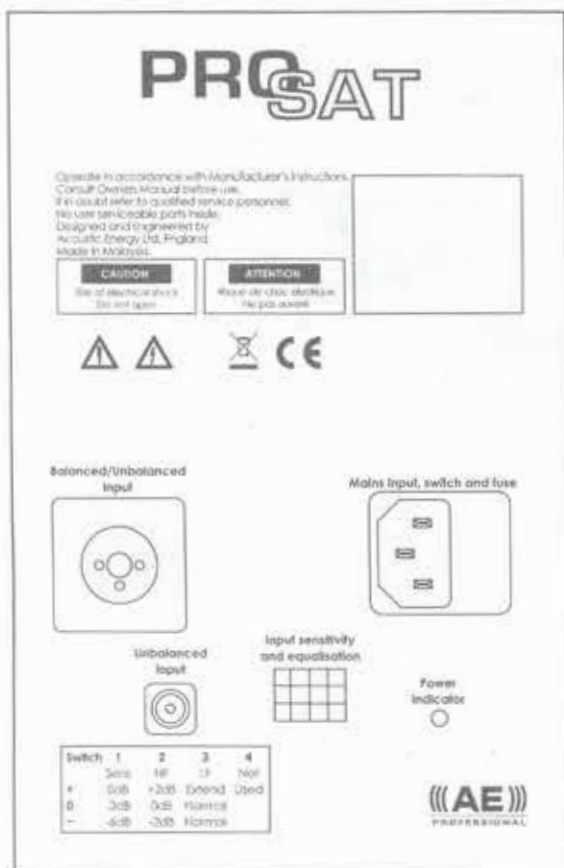

5. Controls

Accompanying the mains and audio input sockets on the ProSat rear panel is a switch array offering input sensitivity, low frequency extension and high frequency equalisation options. Their function and use is described in the following paragraphs.

Input Sensitivity

The input sensitivity switch offer reduction of either 3dB or 6dB. Reducing ProSat input sensitivity can be useful if the monitoring chain output level is too high. Ensure that each ProSat in a monitoring system operates with the same Input Sensitivity setting.

Low Frequency Extension

Low frequency extension can be selected if ProSats are used in desktop or close nearfield monitoring applications without a subwoofer. Engaging LF extension reduces ProSat low frequency cut-off from 90Hz to 75Hz. LF Extension should always be set to Normal if a subwoofer is used. Ensure that each ProSat in a monitoring system operates with the same Low Frequency Extension setting.

Note: Reducing the ProSat LF cut-off frequency will result in reduced ProSat maximum acoustic output level.

High Frequency Equalisation

The high frequency equalisation switch offers cut or boost of 2dB from 2kHz upwards. Adjusting the HF equalisation can help overcome a too bright or too dull acoustic environment. Ensure that each ProSat in a monitoring system operates with the same HF Equalisation setting.

6. Specification

Type: Active, closed-box, two-way compact full range monitor.

Drivers: 130mm aluminium cone LF/MF driver, 25mm ring radiator HF driver.

Frequency Response: 100Hz to 40kHz \pm 3dB

Amplifiers: LF/HF: 50 Watts/HF 25 Watts.

Input Sensitivity: 300mv for rated output

Dimensions [H x W x D]: 220mm x 150mm x 180mm

Weight: 4kg (single, unpacked)

Acoustic Energy reserves the right to modify product specifications.

7. Warranty

The Acoustic Energy ProSat is guaranteed against original defects in materials, manufacture and workmanship for 3 years from the date of purchase.

Under this warranty Acoustic Energy agrees to repair any defect or, at the company's discretion, replace the faulty component(s) without charge for parts or labour. This warranty does not imply any acceptance by Acoustic Energy or its agents for consequential loss or damage and specifically excludes fair wear and tear, accident, misuse or unauthorised modification.

This warranty is applicable in the United Kingdom only and does not in any way limit the customer's legal rights. Claims and enquiries under the warranty for Acoustic Energy products purchased outside the UK should be addressed to the local distributor. If you have reason to claim under the warranty please contact your dealer in the first instance.

8. Contact

Acoustic Energy Limited
16 Bridge Road
Cirencester
Gloucestershire GL7 1NJ
UK

Tel: +44 (0)1285 654432
Fax: +44 (0)1285 654430
Email: info@acousticenergypro.com
Web: www.acousticenergypro.com

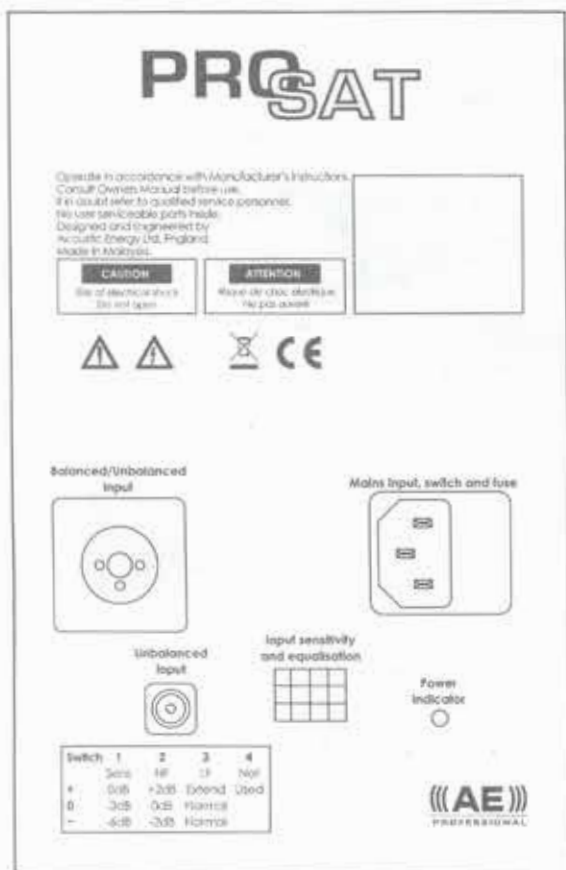

5. Controls

Accompanying the mains and audio input sockets on the ProSat rear panel is a switch array offering input sensitivity, low frequency extension and high frequency equalisation options. Their function and use is described in the following paragraphs.

Input Sensitivity

The input sensitivity switch offer reduction of either 3dB or 6dB. Reducing ProSat input sensitivity can be useful if the monitoring chain output level is too high. Ensure that each ProSat in a monitoring system operates with the same Input Sensitivity setting.

Low Frequency Extension

Low frequency extension can be selected if ProSats are used in desktop or close nearfield monitoring applications without a subwoofer. Engaging LF extension reduces ProSat low frequency cut-off from 90Hz to 75Hz. LF Extension should always be set to Normal if a subwoofer is used. Ensure that each ProSat in a monitoring system operates with the same Low Frequency Extension setting.

Note: Reducing the ProSat LF cut-off frequency will result in reduced ProSat maximum acoustic output level.

High Frequency Equalisation

The high frequency equalisation switch offers cut or boost of 2dB from 2kHz upwards. Adjusting the HF equalisation can help overcome a too bright or too dull acoustic environment. Ensure that each ProSat in a monitoring system operates with the same HF Equalisation setting.

6. Specification

Type: Active, closed-box, two-way compact full range monitor.

Drivers: 130mm aluminium cone LF/MF driver, 25mm ring radiator HF driver.

Frequency Response: 100Hz to 40kHz \pm 3dB

Amplifiers: LF/HF: 50 Watts/HF 25 Watts

Input Sensitivity: 300mv for rated output

Dimensions (H x W x D): 220mm x 150mm x 180mm

Weight: 4kg (single, unpacked)

Acoustic Energy reserves the right to modify product specifications.

7. Warranty

The Acoustic Energy ProSat is guaranteed against original defects in materials, manufacture and workmanship for 3 years from the date of purchase.

Under this warranty Acoustic Energy agrees to repair any defect or, at the company's discretion, replace the faulty component(s) without charge for parts or labour.

This warranty does not imply any acceptance by Acoustic Energy or its agents for consequential loss or damage and specifically excludes fair wear and tear, accident, misuse or unauthorised modification.

This warranty is applicable in the United Kingdom only and does not in any way limit the customer's legal rights. Claims and enquiries under the warranty for Acoustic Energy products purchased outside the UK should be addressed to the local distributor. If you have reason to claim under the warranty please contact your dealer in the first instance.

8. Contact

Acoustic Energy Limited
16 Bridge Road
Cirencester
Gloucestershire GL7 1NJ
UK

Tel: +44 (0)1285 654432

Fax: +44 (0)1285 654430

Email: info@acousticenergypro.com

Web: www.acousticenergypro.com